

APPENDIX 3

THIS IS A PRINT OF THE VIEW OF THE REGISTER OBTAINED FROM HM LAND REGISTRY SHOWING THE ENTRIES SUBSISTING IN THE REGISTER ON 30 NOV 2016 AT 12:57:20. BUT PLEASE NOTE THAT THIS REGISTER VIEW IS NOT ADMISSIBLE IN A COURT IN THE SAME WAY AS AN OFFICIAL COPY WITHIN THE MEANING OF S.67 LAND REGISTRATION ACT 2002. UNLIKE AN OFFICIAL COPY, IT MAY NOT ENTITLE A PERSON TO BE INDEMNIFIED BY THE REGISTRAR IF HE OR SHE SUFFERS LOSS BY REASON OF A MISTAKE CONTAINED WITHIN IT. THE ENTRIES SHOWN DO NOT TAKE ACCOUNT OF ANY APPLICATIONS PENDING IN THE REGISTRY. FOR SEARCH PURPOSES THE ABOVE DATE SHOULD BE USED AS THE SEARCH FROM DATE.

THIS TITLE IS DEALT WITH BY LAND REGISTRY, TELFORD OFFICE.

TITLE NUMBER: TGL66428

There is no application or official search pending against this title.

A: Property Register

This register describes the land and estate comprised in the title.

SOUTHWARK

- 1 (03.11.1986) The Freehold land shown edged with red on the plan of the above Title filed at the Registry and being land lying to the south west of Old Kent Road.
- 2 The land has the benefit of the following rights granted by a Transfer of the land in this title dated 4 November 1991 made between (1) Kwik-Fit (Eastern) Limited (Transferor) and (2) The Mayor and Burgesses of The London Borough of Southwark (Transferee):

"Together with the right to enter onto the retained land for the purposes of maintenance or repair of the supporting columns doing as little damage as possible and making proper compensation for any damage done or occasioned in the exercise of such power and Provided that the Transferee shall (except in the case of an emergency) give to the Transferor one month's notice in writing of its intention to exercise the said right."

B: Proprietorship Register

This register specifies the class of title and identifies the owner. It contains any entries that affect the right of disposal.

Title absolute

- 1 (07.11.1991) PROPRIETOR: THE MAYOR AND BURGESSES OF THE LONDON BOROUGH OF SOUTHWARK of 160 Tooley Street, London SE1 2QH and of PO Box 64529, London SE1P 5LX.

End of register

H.M. LAND REGISTRY		TITLE NUMBER	
		TGL66428	
ORDNANCE SURVEY PLAN REFERENCE ©	COUNTY	SHEET	NATIONAL GRID
	GREATER LONDON		TQ 3477
Scale: 1/1250			SECTION G
© Crown Copyright 1984.			

BOROUGH of SOUTHWARK



NW
NE

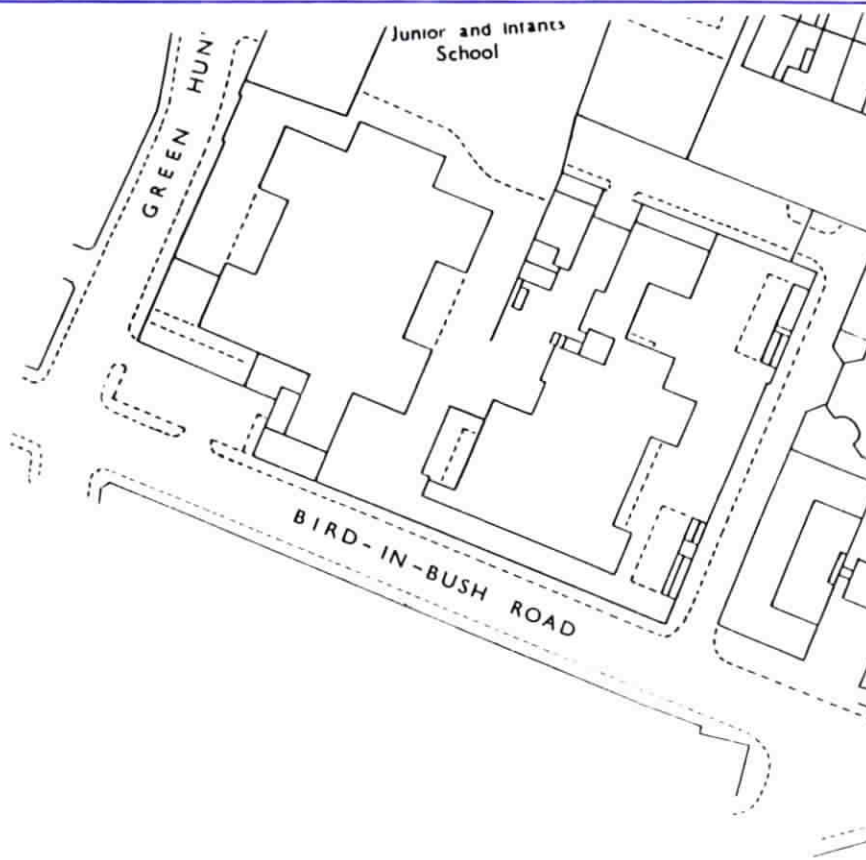
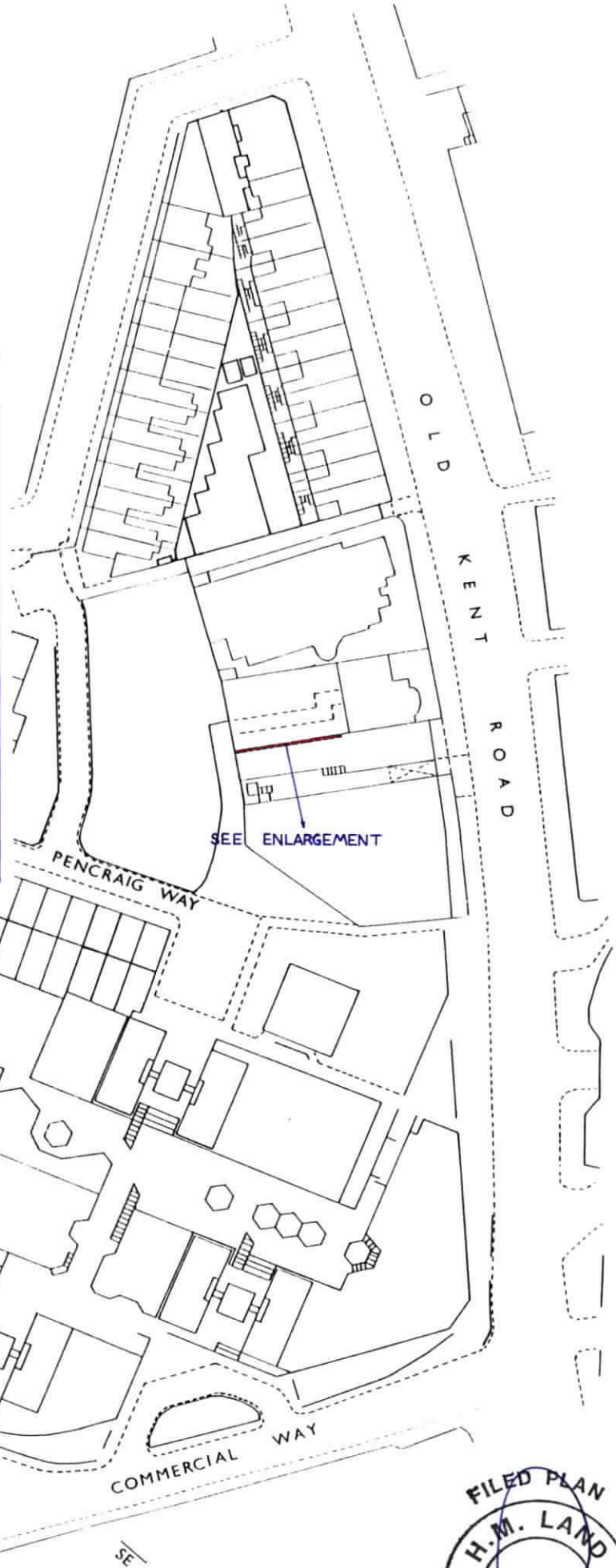
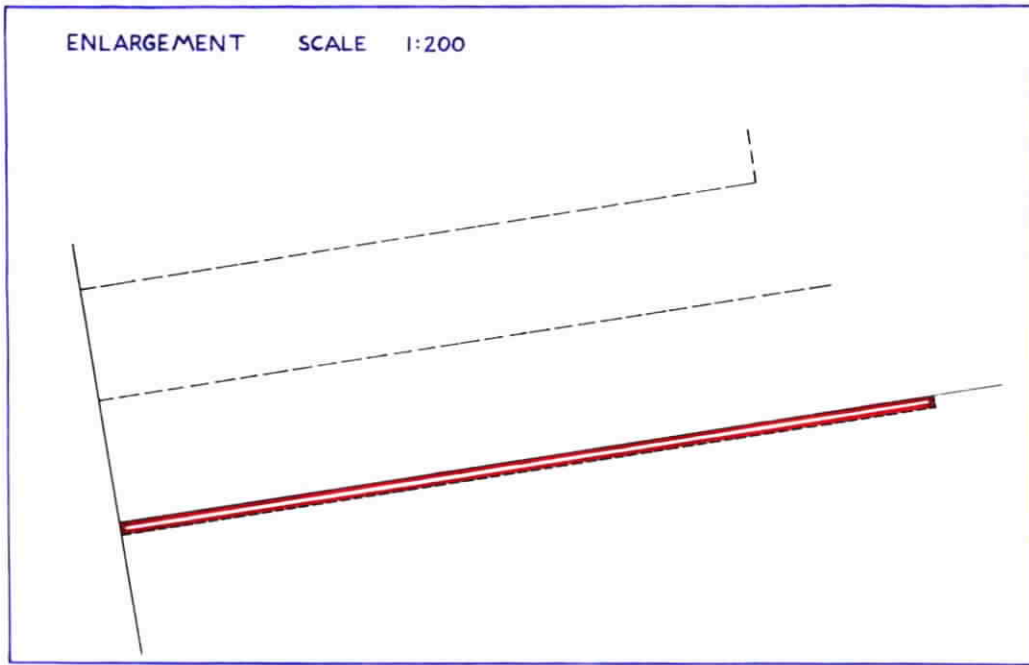

This is a print of the view of the title plan obtained from Land Registry showing the state of the title plan on 30 November 2016 at 12:57:57. This title plan shows the general position, not the exact line, of the boundaries. It may be subject to distortions in scale. Measurements scaled from this plan may not match measurements between the same points on the ground.

This title is dealt with by Land Registry, Telford Office.

©Crown Copyright. Produced by Land Registry. Reproduction in whole or in part is prohibited without the prior written permission of Ordnance Survey. Licence Number 100026316.